



106 -701 Cynthia Street, Saskatoon SK

# FOR LEASE

## WAREHOUSE/OFFICE SPACE

### Available Space:

2,981 SF

Available March 1, 2024

IL1 Zoning

Legal Description: Lot 6 & 10, Block 792, Plan 75S10686

&101439019

Parcels 118931205, 1144882894

Occupancy Costs \$4.75/SF (est)

## NET LEASE RATE:

# \$13.00 SF

### Richard Brindley

O: +1 (306) 665-1416 ext 1184

C: +1 (306) 250-9727

E: richard@reddeeproperties.com

www.reddeeproperties.com

### Building Features:

- Glass store front
- Dedicated parking available
- Three (3) Offices, One (1) Boardroom
- Multiple recent upgrades including parking lot and facade
- Overhead Door and Warehouse space
- Digital Billboard Signage Available

### Location

- 65,000 Daily Traffic Volume at Ave C and Circle Dr.
- Ample on site Parking
- Many restaurants and amenities nearby



**REDDEE**  
PROPERTIES INC.

815 Circle Drive E.  
Saskatoon, SK S7K 3S4

\*Agents Protected

FOR LEASE | 106-701 Cynthia Street, Saskatoon, SK

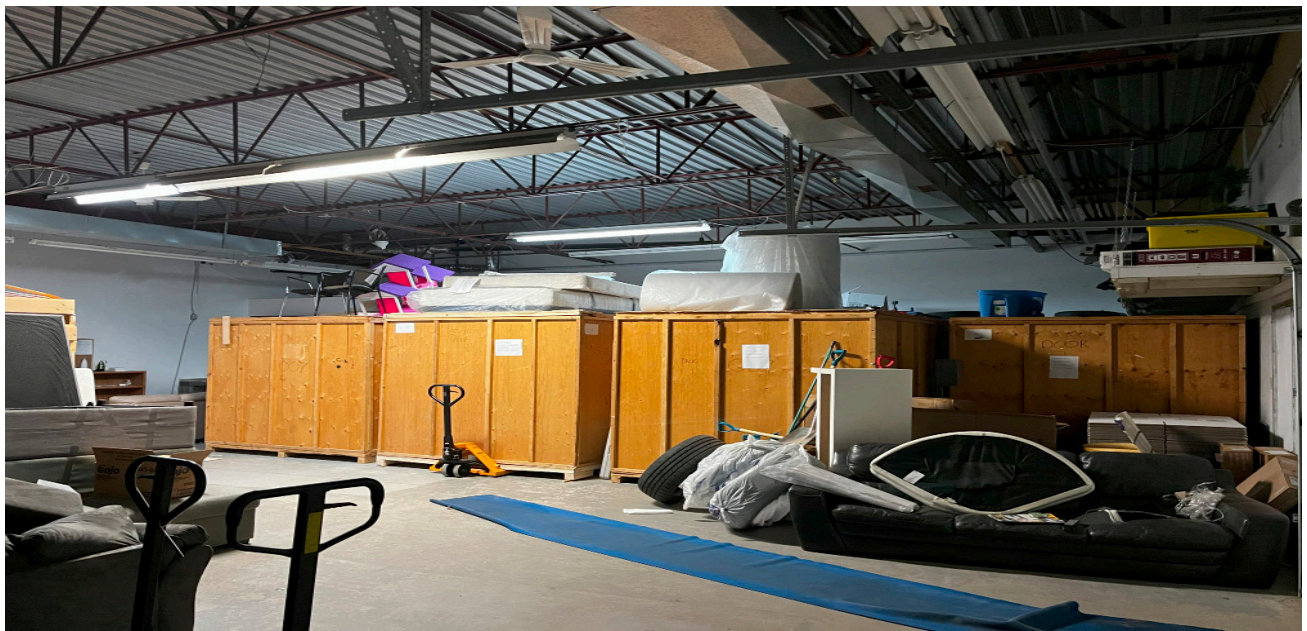

FOR LEASE | 106-701 Cynthia Street, Saskatoon, SK

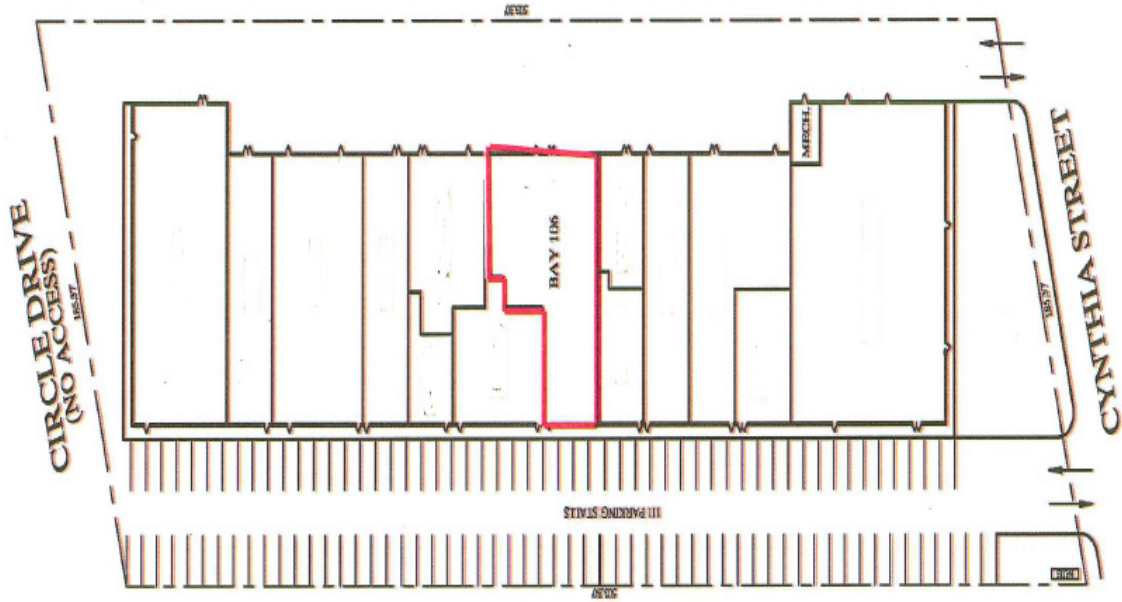

**Signage Available**





**SEE MORE AT:**

[www.reddeeproperties.com/leasing](http://www.reddeeproperties.com/leasing)

***New Office Location at:***

216, 1st Ave S (2nd Floor)  
Saskatoon, SK S7K 1K3

**Richard Brindley**

O: +1 (306) 665-1416 ext 1184

C: +1 (306) 250-9727

E: [richard@reddeeproperties.com](mailto:richard@reddeeproperties.com)

[www.reddeeproperties.com](http://www.reddeeproperties.com)



**REDDEE**  
PROPERTIES INC.

815 Circle Drive E.  
Saskatoon, SK S7K 3S4